

ITC - PACK

By 

All Pack in One



ITC brings you a full package of machines completely assembled for refrigeration and air conditioning system. With GEP standard, we design it to have a highly efficient performance. ITC-pack machine is built in complexity and innovative design (which consists of GEA-FES screw compressors, low side separator, motor for compressor and coupling, dual ammonia circulating pumps, liquid receiver, high side float control, motor starter, control panel and control valve). It is extensively employed in various industries, petrochemical plants and many more. This is our high quality premium package, which widely recognizes for its reliability, versatility and durability. Dazzlingly, all are packed in one.

GEA-FES screw compressor serves as the heart of the system containing refrigerant along the motor. Liquid receiver regulates the high pressure vessel, while the accumulator controls the low pressure vessel and promptly separates the refrigerant (e.g. gas and liquid). Also motor starter, control panel, high side float control device and electrode type level controller maintain a safety control and perform a smooth operation.

I.T.C. (1993) CO., LTD.

10, 12 ซอยรามคำแหง 118 แยก 61 แขวงสะพานสูง เขตสะพานสูง กทม. 10240
10, 12 Soi Ramkhamhaeng 118 Yak 61, Saphansong, Saphansong, Bangkok 10240 Thailand.

Tel : +66-2184-0055

Fax : +66-2184-0065

www.itc-group.co.th

info@itc-group.co.th





ITC - Pack

- ITC-Pack** Include the following equipment and accessories
- GEA - FES Screw Compressor
 - Motor for compressor and coupling
 - Low side separator
 - Dual ammonia circulating pump
 - Critical Charge liquid receiver
 - Motor starter and control panel
 - High side float control
 - Electrode type level controller
 - Neccessaries valve and control valve for the packaged.

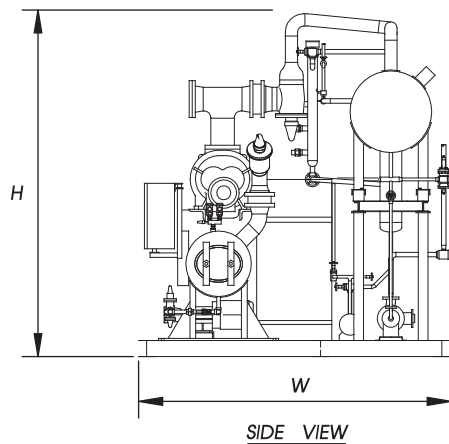
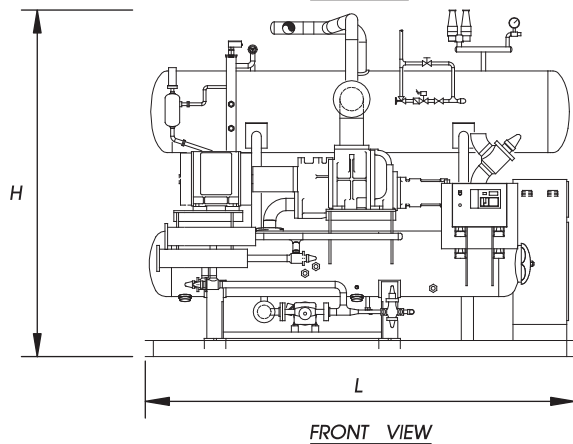
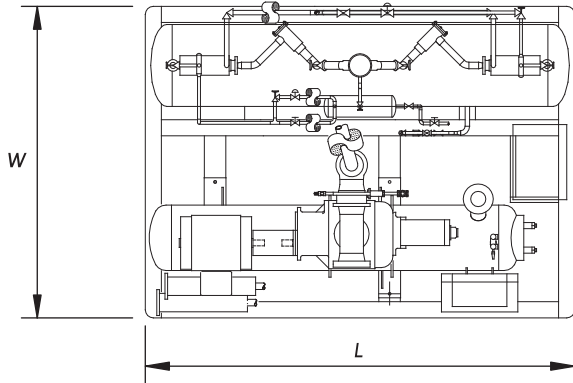

Model	PAK-85GSE	PAK-125GME	PAK-230GLXE	PAK-290GLXE	PAK-340GLXE	PAK-400GLXE	PAK-475GLXE
R-717 Capacity (kW _r)	60	90	185	229	258	317	363
R-717 Installed Motor (HP)	100	150	250	350	350	450	500
R-22 Capacity (kW _r)	76	114	235	288	322	405	404
R-22 Installed Motor (HP)	125	150	300	350	400	500	600
Cond./ Evap. Temp.	+38°/-40 °C						
Refrigerant	R-717 & R-22 Other refrigerant consult Factory						
Electrical (V/Ph/Hz)	400 / 3 / 50						
Overall Width (mm)	2,400		3,000		3,300		
Overall Length (mm)	4,500		5,000		5,300		
Overall Height (mm)	3,000		3,100		3,300		
Appx. Operating Weight (kg)	5400	5700	8,300	8,700	10,500	12,000	12,300

Note : 1.) Other capacity and dimension are available. Please contact manufacturer.
 2.) Specifications subject to change without notice.